

Lithium Jumpstarter and DC power source

INSTRUCTION MANUAL

Read the instruction manual completely before using this product. Retain this instruction for future reference.

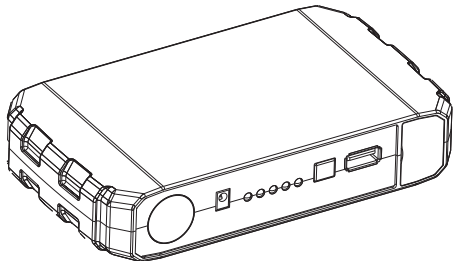

LANDPORT B.V.  
RAMGATSEWEG 63 | 4941 VN RAAMSDONKSVEER - THE NETHERLANDS  
PHONE: +31 (0) 162 58 14 00 | WWW.LANDPORTBV.COM

## CONTENTS

1. Warning	2-3
2. Product feature	3
3. Operation instruction	4-5
3.1 Jumpstart the vehicle	4
3.2 Using USB DC5V/2A outlet	5
3.3 Using high power light	5
4. Charging the internal battery	5
5. Troubleshooting	6
6. Maintenance and care	6
7. Specification	7

## 1. WARNING

**IMPORTANT!** PLEASE READ THE INSTRUCTION MANUAL CAREFULLY, AND OPERATE CORRECTLY ACCORDING TO INSTRUCTION.

**WARNING!** NEVER ALLOW CLAMPS TO TOUCH TOGETHER OR CONTACT THE SAME PIECE OF METAL.

- Do not charge the Jump Starter in dangerous places, such as near fuel, near fire, etc.
- Do not expose the Jump Starter to the sun, rain or snow.
- Do not place the Jump Starter in microwave oven, pressurized container or vacuum chamber.
- Do not charge the Jump Starter with non-standard charger, use only specified charger equipped with Jump Starter.
- Do not immerse the Jump Starter in water or rinse by water, no waterproof design.
- Do not operate the jump starter if it has received a sharp blow, been dropped or otherwise damaged in any way.
- Do not attempt to disassemble, modify, knock and throw the product, please contact your local distributor if the product has any problem.
- Never place the Jump Starter directly above battery being jumped
- Keep out of reach of children.

## 2. PRODUCT FEATURE

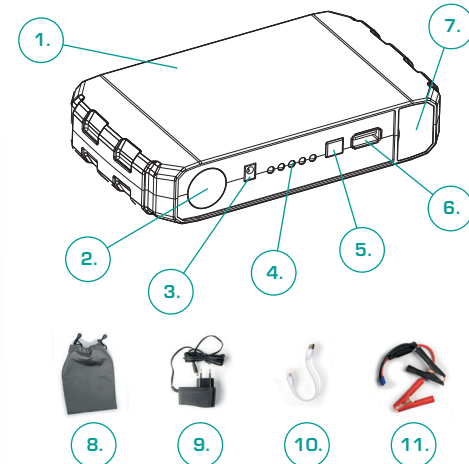

1. Jump Starter

2. High Power LED Light

3. 15V/1A Input port

4. Battery Capacity Indicator

5. POWER/LIGHT Button

6. USB DC 5V/2A Outlet
7. Jumpstart socket

8. Waterproof Bag

9. AC adaptor

10. 5V USB/Micro USB Connector

11. Jump Cable and Clamps (with fuse)

## 3. OPERATING INSTRUCTION

### 3.1 JUMPSTART THE VEHICLE

#### IMPORTANT!

- DO NOT USE THE JUMP STARTER WHILE CHARGING THE INTERNAL BATTERY.
- MAKE SURE THE IGNITION TURNED OFF.
- ONLY USE ON VEHICLES WITH A 12V SYSTEM.

Please follow the below steps strictly, or it may cause damage to the Jump Starter or personal injury or death.

1. Press <POWER/LIGHT> button for at least 1 second to turn on the Jump Starter, it is recommended that the number of lighting indicators be over 3 for Jumpstarting.
2. Connect the RED clamp to the vehicle's battery positive (+)terminal and BLACK clamp to the vehicle's battery negative (-)terminal. **Fig.1**
3. Plug the jump cable into the Jumpstart socket. **Fig.2**
4. Start the vehicle. (turn off all electronic devices to ensure a successfully start.) **Fig.3.** After successfully starting, remove jumper cable from Jump Starter. **Fig.4**
6. Disconnect red and black clamps from the vehicle battery terminals, and remove the clamps from the vehicle battery. **Fig.5**



Fig.1



Fig.2



Fig.3



Fig.4



Fig.5

#### NOTE:

- Please wait for 10 minutes if several fail attempts, then start the vehicle again.
- If the vehicle couldn't be started within 5 seconds, let the Jump Starter cool for 3 minutes before attempting to start the vehicle again, or you may damage the Jump Starter.
- If the ambient temperature is below 0 C, the cranking performance will decrease sharply, the Jump Starter may not start the vehicle successfully. You can try a few attempts to start for warm up the battery and then increase the starting performance.
- If not successful, place the Jump Starter in a warmer area for a short time.

### 3.2 USING USB DC5V/2A OUTLET

The Jump Starter is a DC power source for all DC devices that are equipped with a USB plug.

1. Press <POWER/LIGHT> button for at least 1 second to turn on the Jump Starter.
2. Plug the USB cable into the USB Outlet.
3. Plug the other end (Micro USB) of the cable into your device or use the original charging cable of your device. Turn device on, if necessary.
4. When finished, turn off the device (if necessary) and unplug the device.
5. Press the <POWER/LIGHT> for 3 seconds to turn off the unit or wait for 30 seconds then the Jump Starter will shut down automatically.
6. Recharge the Jump Starter immediately after unplugging the device.

NOTE: Electrical devices must be removed first, or the Jump Starter cannot shut down automatically.

### 3.3 USING HIGH POWER LIGHT

1. Press <POWER/LIGHT> button for at least 1 second to turn on the Jump Starter.
2. Quick press <POWER/LIGHT> button to switch three different LED light modes. (First: Highlight; Second: Strobe; Third: SOS; Fourth: Off)
3. Press <POWER/LIGHT> for 3 seconds to turn off, or wait for 30 seconds then the Jump Starter will shut down automatically.

## 4. CHARGING THE INTERNAL BATTERY

#### IMPORTANT!

CHARGE IMMEDIATELY AFTER PURCHASE, AFTER EACH USE AND EVERY 6 MONTHS, ALWAYS KEEP THE INTERNAL BATTERY FULLY CHARGED.

#### Charged by AC adaptor

- Plug the AC adaptor into Jump starter's charging port.
- Connect the AC adaptor to a 100-240VAC electrical wall outlet, the LED lights flash in the loop.
- Five LED lights on when the internal battery fully charged, Jump Starter will stop charging circuit automatically.
- Disconnect the AC adaptor from the AC outlet, and then unplug the AC adaptor from the Jump Starter.



## 5. TROUBLESHOOTING

PROBLEM	POSSIBLE CAUSE	REMEDIES
The vehicle cannot be jumpstarted	1) Improper clamp connections 2) The internal battery capacity is too low 3) Too low outside temperature	1) Check and make sure the connections is correct 2) Check the internal battery capacity and recharge it if necessary 3) Try starting several times to warm up the battery and then the starting performance increase.
The device cannot be powered	1) Improper clamp connections 2) The USB cable and connectors are defective 3) The internal battery capacity is too low 4) The device of 12V to be powered is over 120W	1) Check and make sure the connections are correct 2) Change a new USB cable and connectors 3) Check the internal battery capacity and recharge it if necessary 4) Make sure the device to be powered is not over 120W
Cannot turn on the Jump Starter	The internal battery capacity is too low	Check the internal battery capacity and recharge it if necessary

## 6. MAINTENANCE AND CARE

- Use only the adaptor included with your Jump Starter to recharge this Jump Starter. Non-standard products will shorten the life of the battery and void the warranty.
- Charge your Jump Starter battery immediately after purchasing.
- Recharge the Jump Starter battery after each use if possible, and thereafter, charge at least once every 6 months.
- When storage, keep the Jump Starter fully charged state.
- Always check if the clamps are clean and if the cable is broken before using.
- Keep your Jump Starter clean by wiping it with a dry cloth, do not use solvents as a cleaning agent.
- Store the Jump Starter at temperature between -10 C-40 C.

#### NOTE:

- The Jump Starter will automatically go into sleep mode after 30 seconds no any output connection.
- Super static power ensure the jump starter can be store for 6-12 months after fully charge state.

## 7. SPECIFICATION

Battery type	12V Lithium Iron Battery
Charger	15V 1.0A AC adaptor
Function	USB DC 5V 2.0A (Max 2.5A)
	Cranking Amps: 100A
	Peak Amps: 200A
Size and length of Jump able and lamps	High Power LED Light (1W)
	12AWG/12.5" (31.8cm)
Weight	0.7 lbs.(330g)
The dimension of Jump Starter	5.6"x3.1"x1.1" (142mm*80mm*28mm)
The working temperature	-10°C - 60°C

Overcharge and overdischarge protection – fuse protection – against-reverse plug.

LANDPORT B.V.  
RAMGATSEWEG 63 | 4941 VN RAAMSDONKSVEER - THE NETHERLANDS  
PHONE: +31 (0) 162 58 14 00 | WWW.LANDPORTBV.COM

